



Weltforum der Medizin
World Forum for Medicine

17 - 20 Nov 2010 Düsseldorf · Germany

MEDICA

17 - 19 Nov 2010
10.00 - 18.30 h
20 Nov 2010
10.00 - 17.00 h
www.medica.de

COMPAMED

17 - 19 Nov 2010
10.00 - 18.30 h
www.compamed.de

Hallen/Halls 1, 2, 3 Labortechnik, Diagnostica Laboratory equipment, diagnostics	Halle/Hall 3
Hallen/Halls 4, 5 Physiotherapie/Orthopädietechnik Physiotherapy/orthopaedic equipment	Halle/Hall 4
Hallen/Halls 5, 6, 7.0, 7.1, 7a Bedarfs- und Verbrauchsartikel, Textilien Disposables, commodities and consumer goods, textiles	
Hallen/Halls 8a, 8b COMPAMED High tech solutions for medical technology	Halle/Hall 8a Forum Hightech for Medical Devices
Hallen/Halls 9 - 14 Elektromedizin, Medizintechnik, OP-Technik und Einrichtung Electromedicine, medical technology, operating technology and equipment Krankenhauseinrichtung, Kommunikations-Systeme Hospital equipment, communication systems	Halle/Hall 11
Halle/Hall 15 Informations- und Kommunikationstechnik Information and communications technology	Halle/Hall 15
Hallen/Halls 16, 17 Nationale und internationale Gemeinschaftsstände, Elektromedizin, Medizintechnik National and international joint participants, electromedicine, medical technology	
CCD Süd CCD Ost CCD Pavillon	
CCD Ost	
Eingang Nord/Mall Entrance North/Mall	

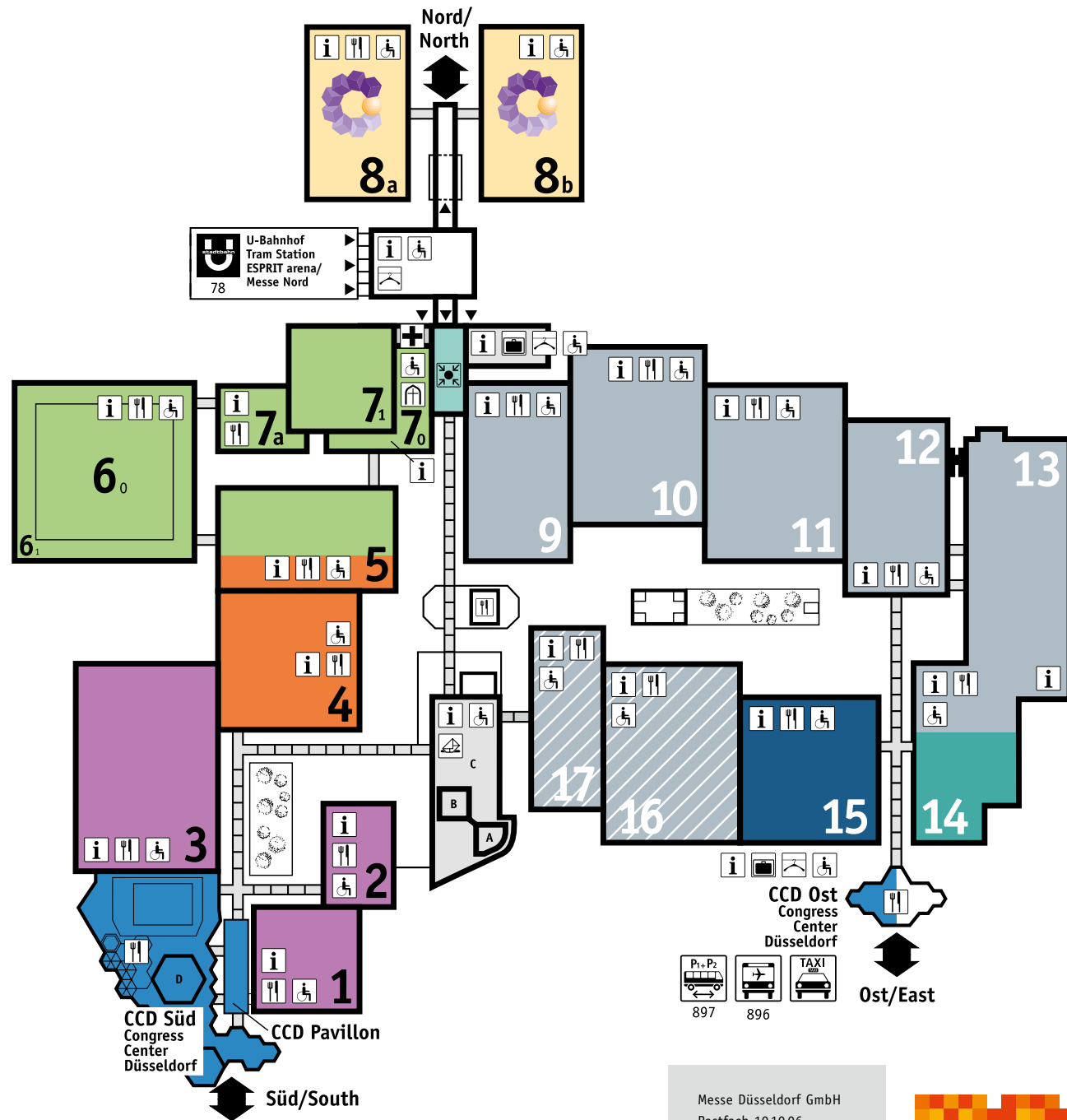

P1+P2 897
 896
 TAXI
CCD Ost Congress Center Düsseldorf
Ost/East

Messe Düsseldorf GmbH
 Postfach 10 10 06
 40001 Düsseldorf
 Germany
 Tel. +49 (0) 211/45 60-01
 Fax +49 (0) 211/45 60-6 68
www.messe-duesseldorf.de

